

STAR Pro SERIES N-TOPCon 120-cell MODULE

EG-485NT60-HLV (black)

465~485W

0~3% POSITIVE TOLERANCE

KEY FEATURES



SMBB cell design

Super multi Busbar cells bring lower resistance and increased Busbar reflectance ensures higher power output



Low degradation

Adopt N-Type TOPCon cell technology, lower degradation and better temperature co-efficiency, greatly increased on generation performance



High Reliability

Strict in-house testing in PV Lab which is CNAS approved & TUV /VDE certified



Excellent Low-light Performance

Advanced solar cell and glass surface texturing technology allows for excellent performance in low-light environments



PID Resistant

Excellent PID resistance performance optimized by unique structural design

LINEAR PERFORMANCE WARRANTY



15 year Product Warranty
25 Year Product Warranty
(Optional, special for rooftop market)



30 Year Linear Power Warranty

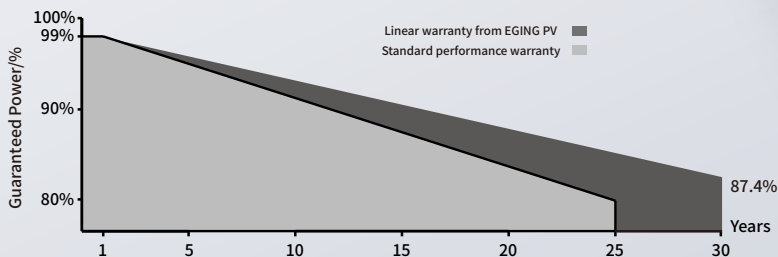

As a BloombergNEF Tier 1 and global leading manufacturer since 1998, EGING PV is committed to supplying reliable and durable PV products to customers to create together a greener planet.

EG-485NT60-HLV(black)

Engineering Drawings

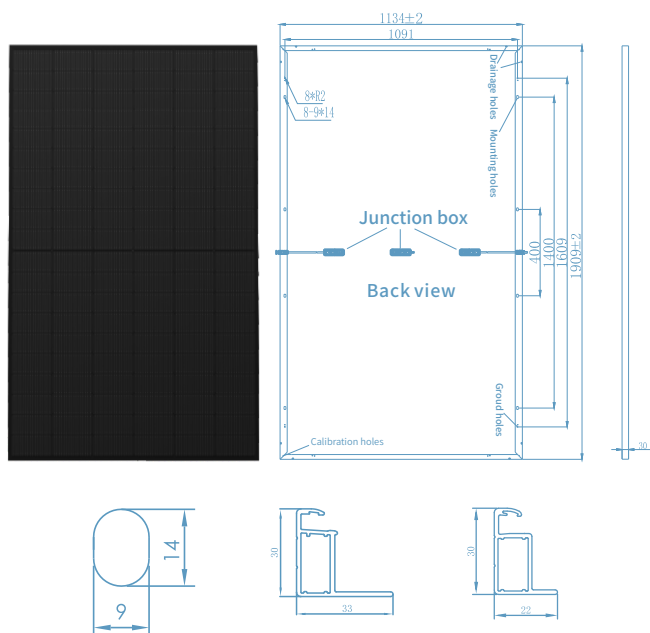

I-V Curves

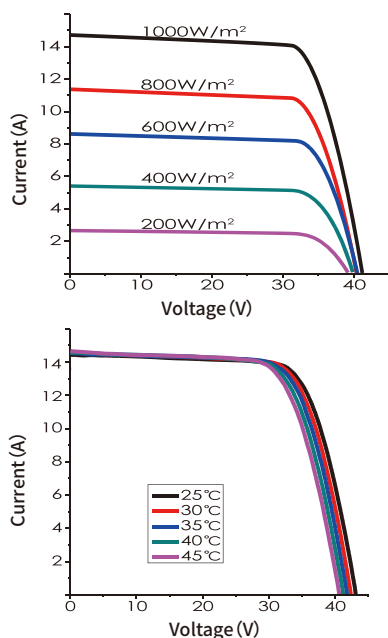

Packing Configuration

Pieces per pallet	36
Size of packing (mm)	1940*1135*1255
Weight of packing (kg)	848
Pieces per container	864
Size of container	40' HC

Electrical Characteristics

Power level	465	470	475	480	485
Pmax (W)	465	470	475	480	485
Vmp (V)	34.81	34.98	35.14	35.30	35.46
Imp (A)	13.36	13.44	13.52	13.60	13.68
Voc (V)	42.35	42.63	42.84	43.07	43.30
Isc (A)	14.08	14.16	14.24	14.32	14.40
Module efficiency (%)	21.5	21.7	21.9	22.2	22.4
Maximum system voltage (V)	1500				
Fuse Rating (A)	25				
Temperature coefficient Pmax (%/°C)	-0.29				
Temperature coefficient Isc (%/°C)	0.046				
Temperature coefficient Voc (%/°C)	-0.24				

STC:Irradiance 1000W/m²,module temperature 25°C,AM=1.5

Working Characteristics

Power level	465	470	475	480	485
Pmax (W)	350	353	357	361	365
Vmp (V)	32.81	32.90	33.09	33.28	33.43
Imp (A)	10.67	10.73	10.79	10.85	10.92
Voc (V)	40.08	40.23	40.39	40.55	40.71
Isc (A)	11.37	11.43	11.50	11.56	11.62
Power tolerance (%)	0~+3				
NOCT (°C)	44±2				

NOCT:Conditions:Irradiance 800W/m²,ambient temperature 20°C, wind speed 1m/s

Mechanical Characteristics

Number of cells	120pcs
Size of cell (mm)	182*91
Type of cell	N-type Mono
Thickness of glass (mm)	3.2
Type of frame	Anodized aluminum alloy
Junction box	IP68
Size of module (mm)	1909*1134*30
Weight (kg)	22.3
Cables/connectors	4mm², MC4 compatible
Length of Cable	Portrait: +300mm/-300mm

Maximum Ratings

Operating Temperature(°C)	-40~85
Operating humidity(%RH)	5~85
Allowable Hail Load	25mm ice-ball with velocity of 23m/s

Revised in October 2024 1st Edition*

CAUTION:All rights and explain reserved by EGING PV.
Specifications included in this datasheet are subject to change without notice.
The specific content of the product warranty refers to EGING's latest warranty.



Tel:86-519-82585880
Zip:213213
Add: No.18,Jinwu Road,Jintan Dist,
Changzhou City,Jiangsu Province.
Email: marketing@egingpv.com
Web:www.egingpv.com